

Two-Room Housing 3/UP-2BR With Fire Protection Device

Description

Two-room flush-mounted housing with fire protection coating, suitable for wall installation in shaft walls with side exhaust vent (DN 80), leakage-airtight backdraft shutter and connecting piece (DN 80) for a second room.

All ventilator inserts of the Silvento series can be inserted into the flush-mounted housing.

Incl. mounting bracket, sound absorber

Installation

The installation of the housing is made by flush finish on the wall and ventilation using the Alu-Flex pipe DN 80 to the main line. For the second room, the Alu-Flex pipe DN 80 is connected to the second-room connecting piece.

In the adjacent room itself, the fire-protection set 8/B2 is installed and connected to the flex pipe.

Please observe the installation manual and have the electrical connection of the fan performed by a qualified professional.

Accessories

Second-room connection with fire protection nozzle 8/B2
Fire protection - shut-off device with nozzle 8/BS
Alu-Flex pipe DN 80

Technical data

Power supply 230 V AC 50 Hz
Dimensions (W x H x D) in mm 270 x 270 x 102.5
Available static pressure 233 Pa

The ventilation unit is provided with protective insulation; a protective conductor terminal is not required.

Further details

Product data
Brand LUNOS
Type 3/UP-2BR
Order No. 039 187

Manufacturer's warranty: 2 years

Note

Products and illustrations may vary slightly. Due to continuous product development and/or several suppliers e.g. for raw materials, colours, among other things, may vary slightly or be shown differently in brochures.

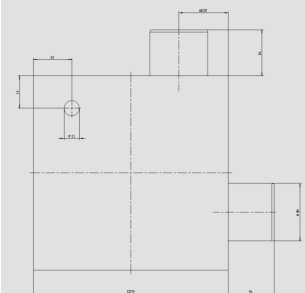
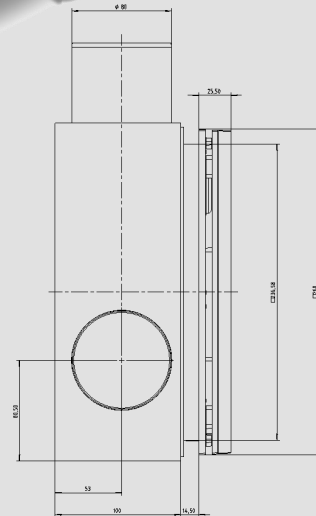

Pressure-volume characteristic curve 3/UP-2BR

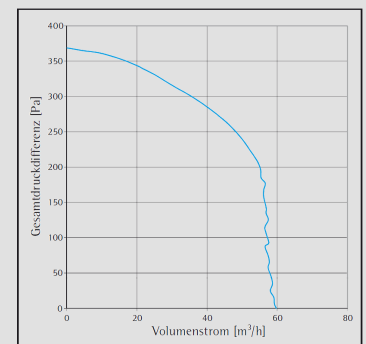

E267 04.16 EN

Editing status: April 2016