

Two-Room Housing 3/UP-2BA With Fire Protection Device

Description

Two-room flush-mounted housing with fire protection coating, suitable for wall installation in shaft walls with rear exhaust vent (DN 80), leakage-airtight backdraft shutter and connecting piece (DN 80) for a second room.

All ventilator inserts of the Silvento series can be inserted into the flush-mounted housing.

Incl. mounting bracket, sound absorber and plaster protection cap for dirt protection.

Installation

The installation of the housing is made by flush finish on the wall and ventilation using the Alu-Flex pipe DN 80 to the main line. For the second room, the Alu-Flex pipe DN 80 is connected to the second-room connecting piece.

In the adjacent room itself, the fire-protection set 8/B2 is installed and connected to the flex pipe.

Please observe the installation manual and have the electrical connection of the fan performed by a qualified professional.

Accessories

Second-room connection with fire-protection nozzle 8/B2
Fire protection - shut-off device with nozzle 8/BS
Alu-Flex pipe DN 80

Technical Data

Power supply 230 V AC 50 Hz
Dimensions (W x H x D) in mm 270 x 270 x 102.5
Available static pressure 212 Pa

The ventilation unit is provided with protective insulation; a protective conductor terminal is not required.

Further details

Product data
Brand LUNOS
Type 3/UP-2BA
Order No. 039 195

Manufacturer's warranty: 2 years

Note

Products and illustrations may vary slightly. Due to continuous product development and/or several suppliers e.g. for raw materials, colours, among other things, may vary slightly or be shown differently in brochures.

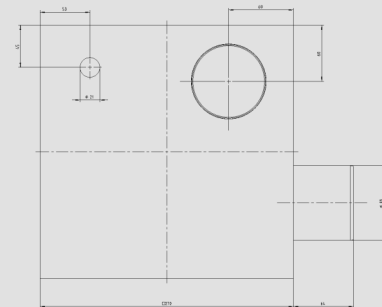
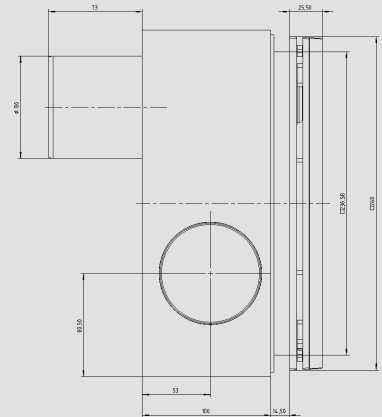

Pressure-volume characteristic curve

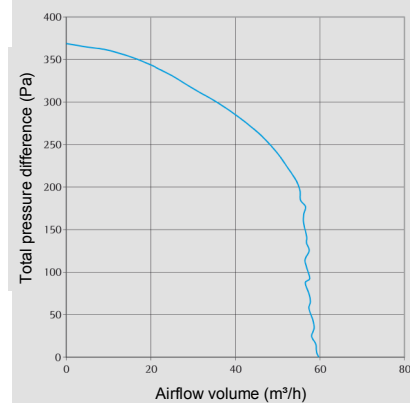

E266 04.16 EN

Editing status: April 2016